

# Bar Cap Clip-On

Standard material is white UHMW supplied in lengths or coils

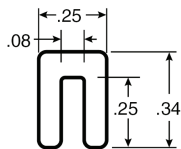

1/16"

**CV-390**

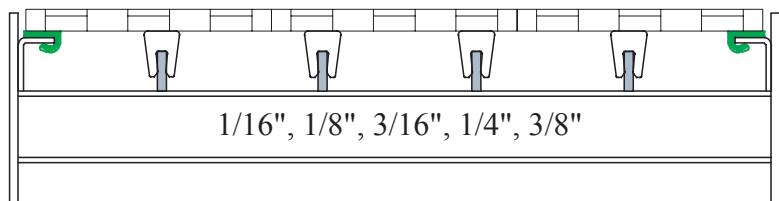

Modular belt supports are available to fit different thickness of conveyor frames.

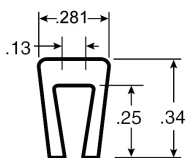

1/8"

**CV-391**

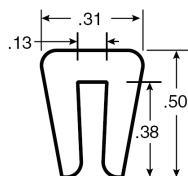

1/8"

**CV-391D**

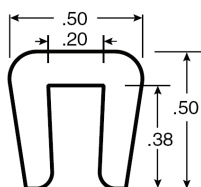
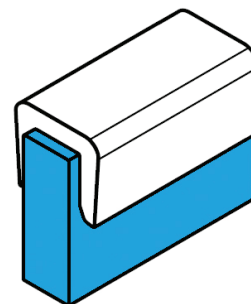

3/16"

**CV-396D**

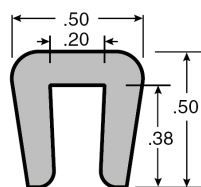

3/16"

**CV-298PL**

Grey oil filled UHMW

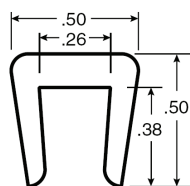

1/4"

**CV-392**

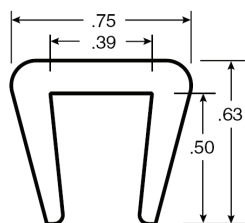

3/8"

**CV-394**

