

HabaCHAIN[®]

Solid Sprockets - Series 1250



Description

Solid sprocket for all 1250 series chains. Standard sprocket has a pilot bore. Bore configurations can be machined according to the customer requirements.

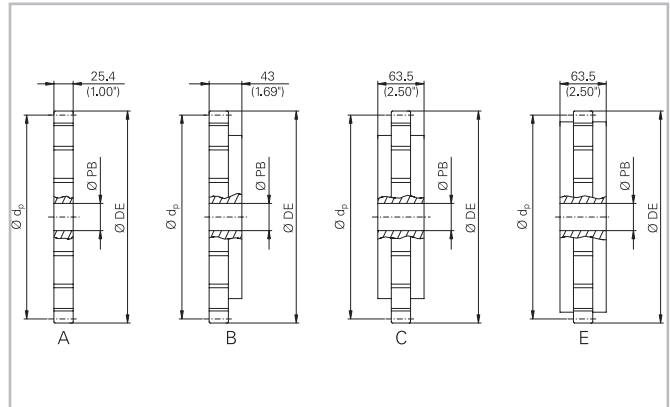

Sprocket data

Habasis code	Number of teeth	Diam. of pitch $\text{\O} d_p$		Available hub type				Material
		mm	inch					
C1250M08NY	8	166.0	6.54	A	B	C	E	NY
C1250M08PE	8	166.0	6.54	A	B	C	E	PE
C1250M12NY	12	245.0	9.65	A	B	C	E	NY
C1250M12PE	12	245.0	9.65	A	B	C	E	PE
C1250M15NY	15	306.0	12.05	A	B	C	E	NY
C1250M15PE	15	306.0	12.05	A	B	C	E	PE
C1250M17NY	17	346.0	13.62	A	B	C	E	NY
C1250M17PE	17	346.0	13.62	A	B	C	E	PE

- Standard material = UHMW-PE

For further information and availability please contact your local Habasis partner.

Product liability, application considerations

If the proper selection and application of Habasis products are not recommended by an authorized Habasis sales specialist, the selection and application of Habasis products, including the related area of product safety, are the responsibility of the customer.

All indications / information are recommendations and believed to be reliable, but no representations, guarantees, or warranties of any kind are made as to their accuracy or suitability for particular applications. The data provided herein are based on laboratory work with small-scale test equipment, running at standard conditions, and do not necessarily match product performance in industrial use. New knowledge and experiences can lead to modifications and changes within a short time without prior notice.

BECAUSE CONDITIONS OF USE ARE OUTSIDE OF HABASIS'S AND ITS AFFILIATED COMPANIES CONTROL, WE CANNOT ASSUME ANY LIABILITY CONCERNING THE SUITABILITY AND PROCESS ABILITY OF THE PRODUCTS MENTIONED HEREIN. THIS ALSO APPLIES TO PROCESS RESULTS / OUTPUT / MANUFACTURING GOODS AS WELL AS TO POSSIBLE DEFECTS, DAMAGES, CONSEQUENTIAL DAMAGES, AND FURTHER-REACHING CONSEQUENCES.